

General Notes

SLAB OPTION: The superstructure option shown on this Standard Drawing may be used in lieu of composite or non-composite adjacent box beams. Notify the Director of the Division of Structural Design when this option is used.

CLASS "AA" REINFORCED CONCRETE: All falsework is to remain in place until the Class "AA" Concrete compressive strength is 4000 PSI. Class "AA" Concrete is to be used throughout the superstructure.

ELEVATIONS: Determine final elevations using the elevations, slopes, and grades shown on the detailed plans.

STEEL REINFORCEMENT: Ensure steel reinforcement is ASTM A 615 Grade 60 and epoxy coated.

SURFACE FINISH: The top of the slab surface may be finished with a floated surface finish in accordance with Section 601.03.18 and textured in accordance with Section 609.03.10.

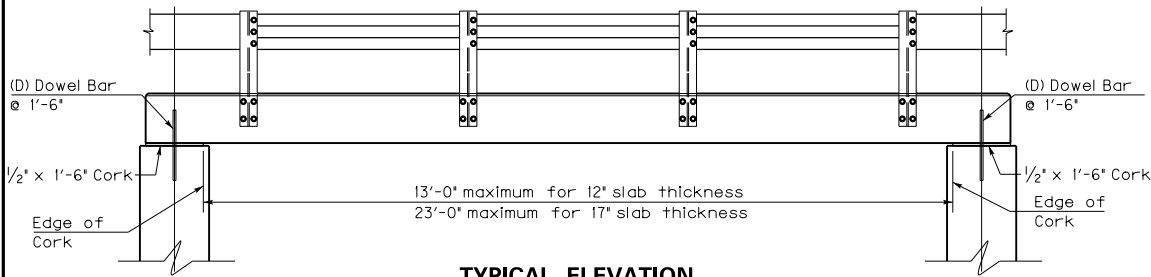

TYPICAL ELEVATION

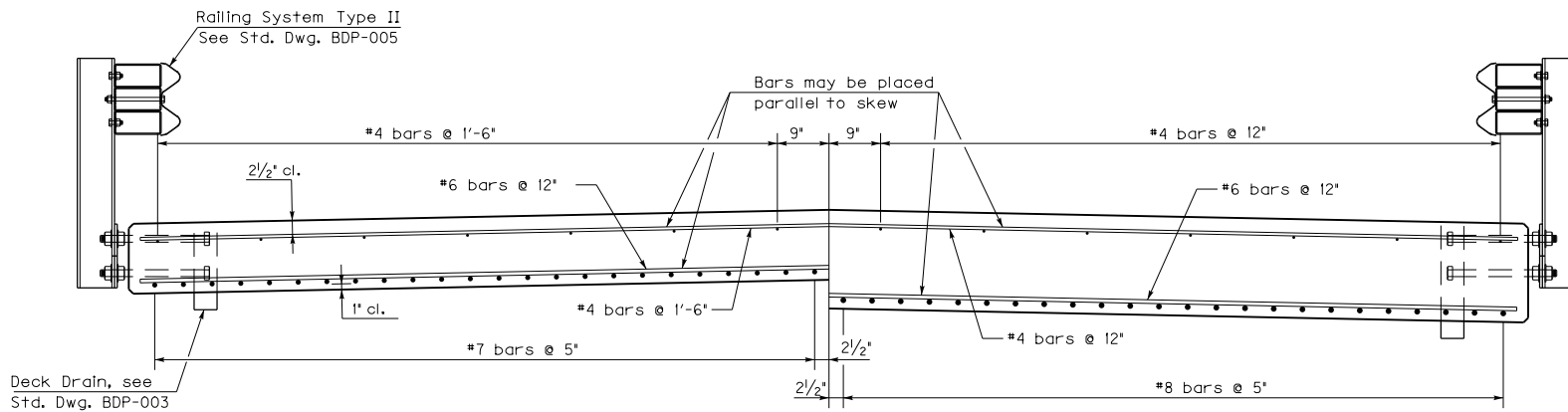

Half-Section showing 12" Slab

Half-Section showing 17" Slab

TYPICAL SECTION OF CAST-IN-PLACE SLAB

KENTUCKY DEPARTMENT OF HIGHWAYS	
SLAB BRIDGE FOR 12" & 17" BEAMS	
STANDARD DRAWING NO. BDP-013-03	
SUBMITTED <i>Mad</i>	DATE 12-01-15
DIRECTOR, DIVISION OF STRUCTURAL DESIGN	DATE
APPROVED <i>Sh</i>	DATE 12-01-15
STATE HIGHWAY ENGINEER	DATE